

LEGEND

-  TREES TO BE PROTECTED
-  TREES TO BE REMOVED

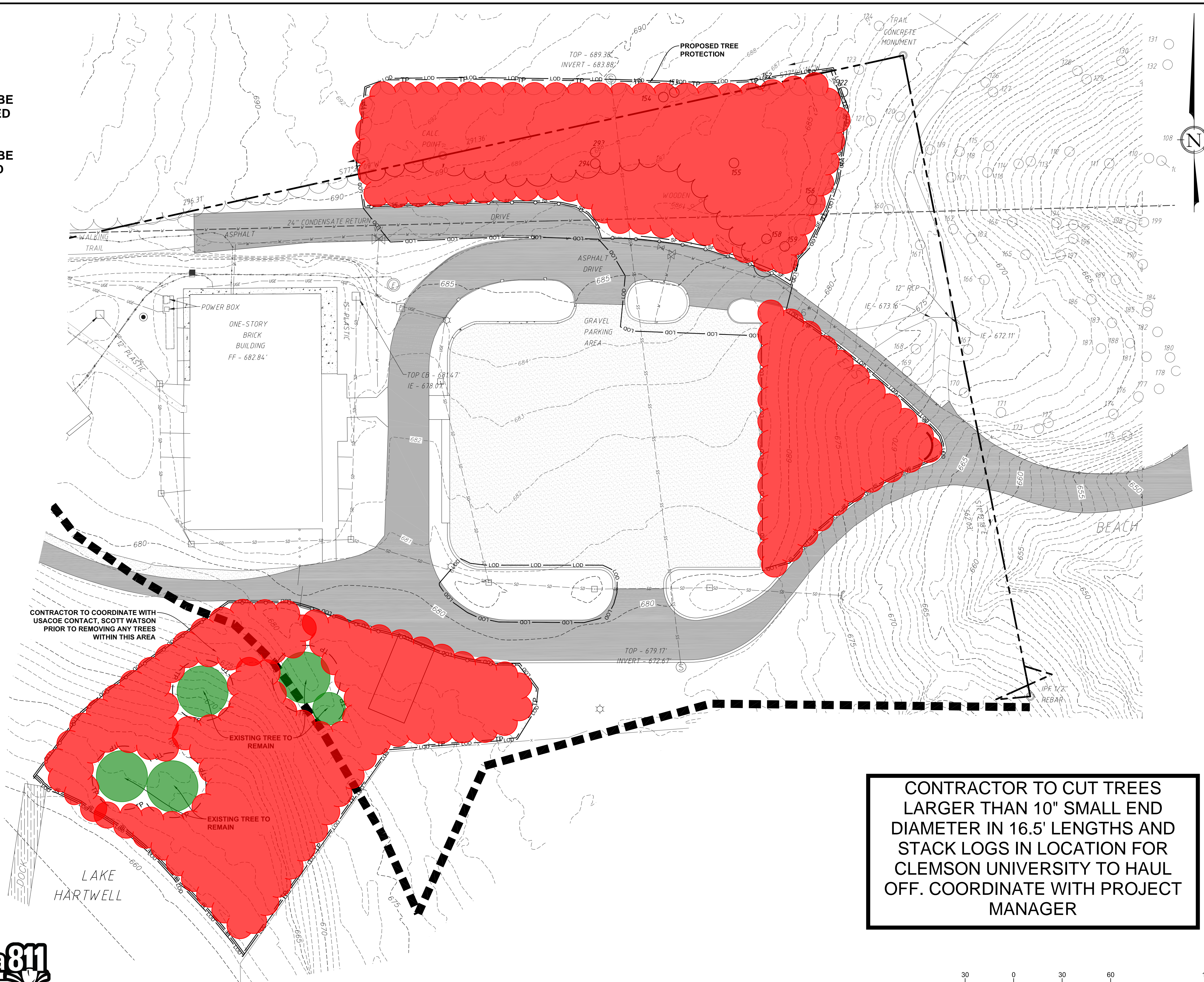

CONTRACTOR TO COORDINATE WITH USACOE CONTACT, SCOTT WATSON PRIOR TO REMOVING ANY TREES WITHIN THIS AREA

EXISTING TREE TO REMAIN

EXISTING TREE TO REMAIN

CONTRACTOR TO CUT TREES LARGER THAN 10" SMALL END DIAMETER IN 16.5' LENGTHS AND STACK LOGS IN LOCATION FOR CLEMSON UNIVERSITY TO HAUL OFF. COORDINATE WITH PROJECT MANAGER

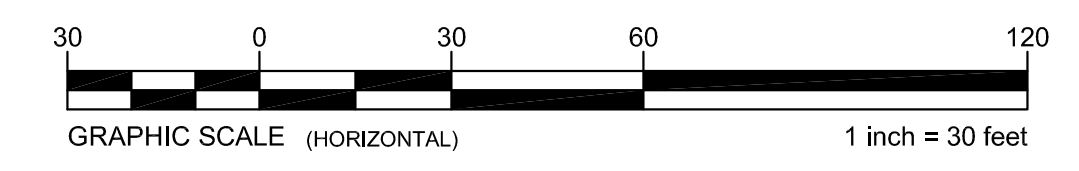

WHEN PLOTTED AT FULL SIZE THIS SHEET MEASURES 22"x34"

NO.	DATE	REVISIONS DESCRIPTION	BY

PRELIMINARY
(NOT FOR CONSTRUCTION)

BEESON - ROSIER GROUP
Engineers & Surveyors
110 W. First Avenue Suite 1D
Essex, S.C. 29540 (803) 689-9900

THIS DRAWING IS THE PROPERTY OF BEESON-ROSIER GROUP. IT IS NOT TO BE REPRODUCED, COPIED, OR TRANSMITTED IN ANY FORM OR BY ANY MEANS, WITHOUT THE WRITTEN CONSENT OF BEESON-ROSIER GROUP.

CLEMSON UNIVERSITY



ROWING, PUBLIC ACCESS, EXPANSION, AND ADDITIONAL PARKING
TREE REMOVAL EXHIBIT

SCALE:	1"=30'
DESIGNED BY:	WWC
DRAWN BY:	CAS
DATE:	1/9/19
JOB NUMBER:	18.040
PAGE #:	

EXHIBIT 1



C:\Users\Stacey\Documents\18_040_Rowing Civil Set.dwg | Layout: C-104 TREE PROT | Mar 01, 2019 at 12:46 by Stacey